

- Designed to Activate Eyewashes
- Easy to Install
- Made from Corrosion-Resistant Materials
- Full, One-Year Warranty

Specifications

Several foot treadle kits are available to meet your individual needs. They are shipped with all components necessary to fully install the product. When a fixture has been activated via the foot treadle, the hand valve must be used to manually reset the fixture after activation. Either the foot treadle or the eyewash handle can be used to activate the eyewash after the pedal is installed. The installation of this kit complements ANSI-compliant fixtures and does not compromise the current fixture's compliance.

Standard Equipment

Some kits may differ slightly from others, but the majority include a foot treadle valve handle, an S-hook, a chain, the foot treadle, washers, screws, nuts and installation instructions. All components will be included to retrofit any Bradley compatible unit.

Model	Description
<input type="checkbox"/> S39-395	304 Stainless Steel Tube Foot Treadle Kit for Wall-Mounted Units
<input type="checkbox"/> S45-572	Foot Treadle Kit for Models with Plastic Handles or Stainless Steel Dust Cover
<input type="checkbox"/> S45-620	Foot Treadle Kit for PVC Fixtures Only
<input type="checkbox"/> S45-1314SS	All Stainless Steel Foot Treadle Kit
<input type="checkbox"/> S45-1314SS16	316 Stainless Steel Foot Treadle Kit

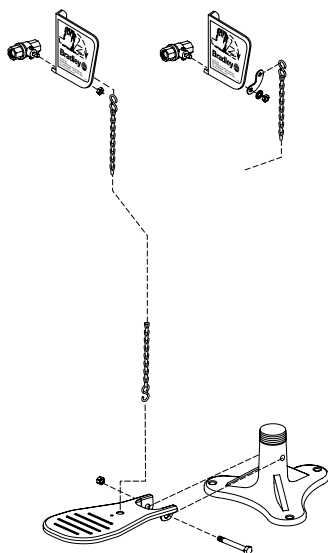

S45-1314SS and
S45-1314SS16

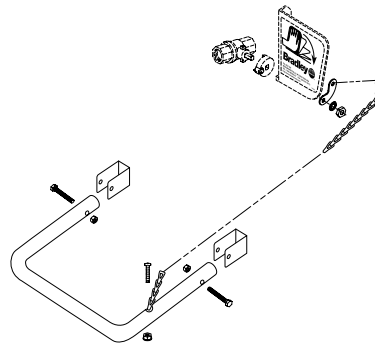

S39-395

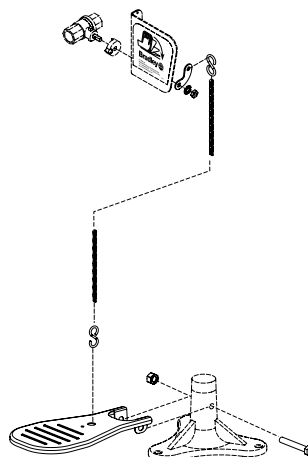

S45-572

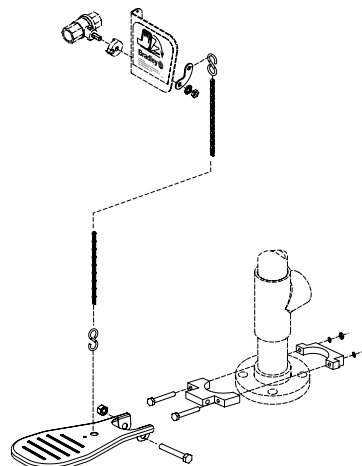

S45-620